

## KIND NET kit 203/AP

K203KIND/AP

High net back task chair, Punta aluminum base, mechanism Whale, Ryde sliding seat, Zodiac aluminum adjustable armrests, headrest

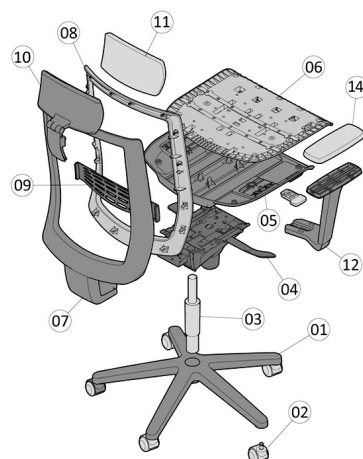

	CODE	DESCRIPTION	QUANTITY USED
1	BAM07001AL	PUNTA maxi base, Ø 680mm, aluminium	x 1
2	RUP0021NR	Rubber free castor Ø 50mm, pin Ø 11mm, black	x 5
3	ALM41901FC	Tapered gas lift 50x28x210mm, class IV, run 125mm, chromed	x 1
4	SYM04513	WHALE synchronized mechanism, backrest tilt angle adjustment with 5 locking positions, antishock, handwheel adjustment	x 1
5	SSP375ANR	RYDE sliding outer seat, 10° armrests inclination, black	x 1
6	SDZ177X86AHP	RYDE reinforced sliding inner seat for SSP375, with metal bars, run 60-72mm, 14 t-nuts	x 1
7	SCY518BNR	KIND outer backrest frame for mesh, new version, black nylon	x 1
8	SHS262AN1	KIND front frame for mesh for SCY518, black	x 1
9	ACP188NR	KIND lumbar support for mesh task chair, black	x 1
10	ACY213NRR	KIND headrest for mesh task chair, assembled, black nylon	x 1
11	ACI067BC	Headrest foam to be upholstered, with insert, - 60-65 kg/m3	x 1
12	BRY212CAHDNR	ZODIAC adjustable arm with aluminium 10° bracket, right 2D, run 80mm, slide pad 58mm, black	x 1
13	BRY212CAHSNR	ZODIAC adjustable arm with aluminium 10° bracket, left, 2D, run 80mm, slide pad 58mm, black	x 1
14	ACU185NR	ZODIAC polyurethane pad, black	x 2
15	VTM0516BPCFB	Hilo screw tip Ø10.5 truss head 5x16mm, bronzed	x 11
16	VTM0516BPCFZ	Hilo screw wide combo truss head e-lock 5x16mm, zinc-plated	x 2
17	VTM0620BPCFB	Screw wide combo truss head M6x20mm, bronzed	x 4
18	VTM0640BPCFB	Screw wide combo truss head M6x40mm, bronzed	x 6
19	VTM0820BPBFB	Screw hex recess truss head M8x20mm, bronzed	x 3
20	* SDI177A	RYDE seat foam D.60, classe 1 IM	x 1
*: optional kit components			